



Medari

My infectious disease diary to
return to daily life



My infectious disease diary to return to daily life

Installation and use of **MEDARI**

Dankook Univ. College of Public Health Sciences

Research Manager : Mijung Rho

National Research Foundation of Korea

CONTENTS

- 1.** Installation Method
- 2.** Sign Up
- 3.** Consent to use location information
- 4.** How to use MEDARI – HOME
- 5.** How to use MEDARI – My Data

1. Installation Method



“The Android robot is a reproduction or modification of a work created and shared by Google and is used under the terms and conditions of the creative commons 3.0 Author Indication License.”

If your phone is Android,
**Download and install the .apk file
from your phone**

2. Sign Up

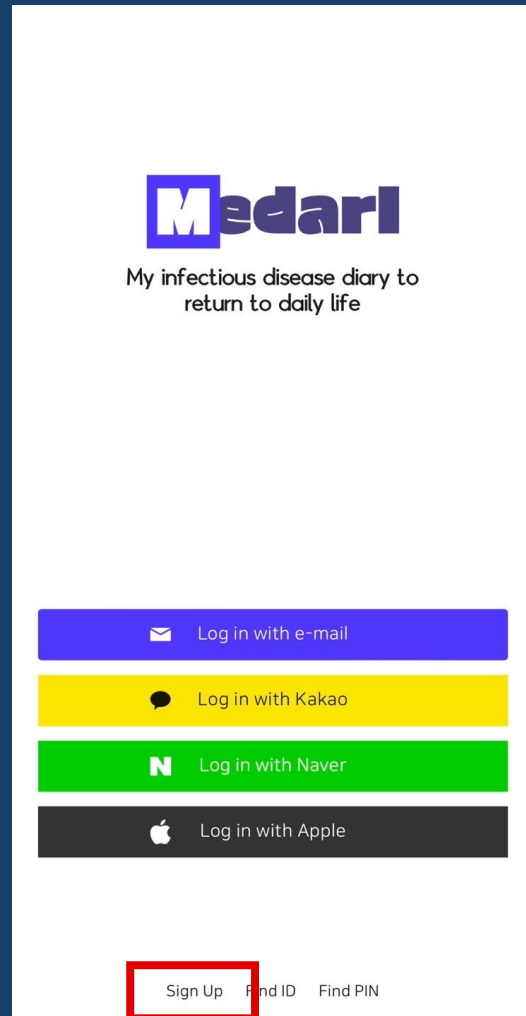

< MEDARI Start Screen

After running Medari,
Press the sign-up button to sign up

2. Sign Up

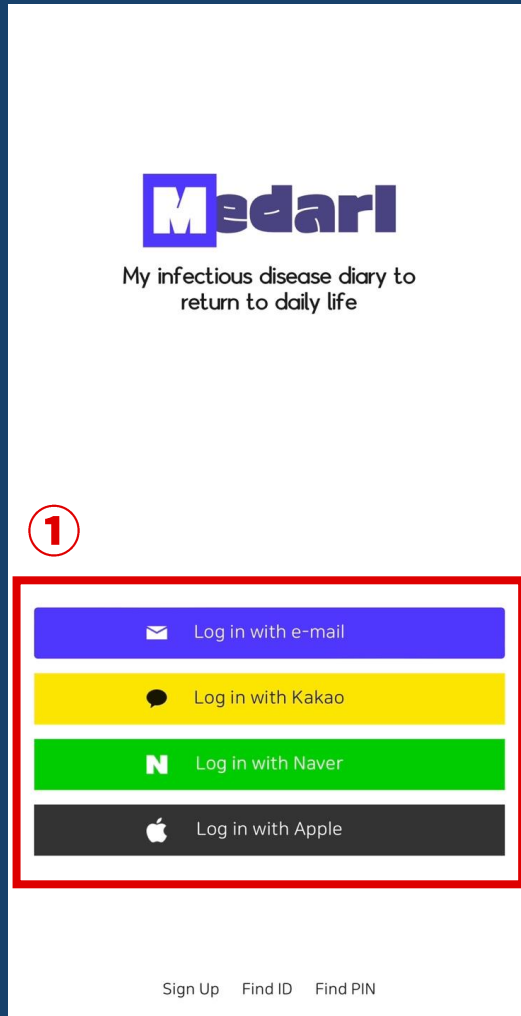

- ① Log in the way you signed up
- ② Enter PIN number and run MEDARI

3. Consent to use location information

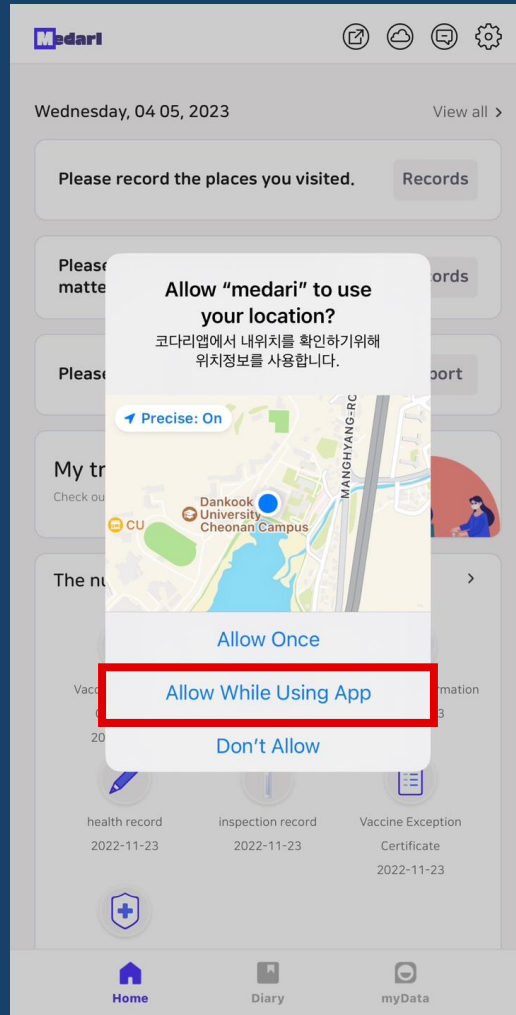

When running it on iPhone

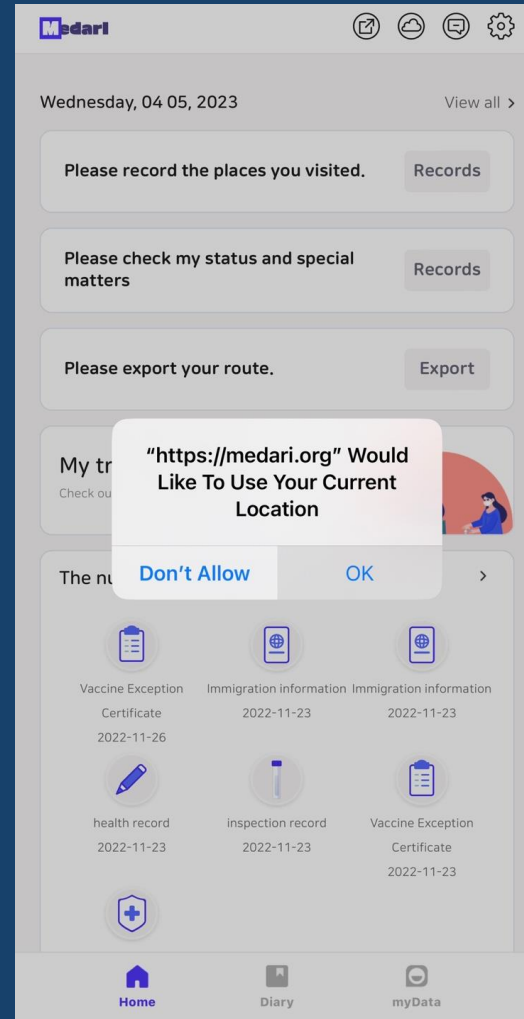

Select 'Allow While Using App' when pop-up appears

3. Consent to use location information – iPhone

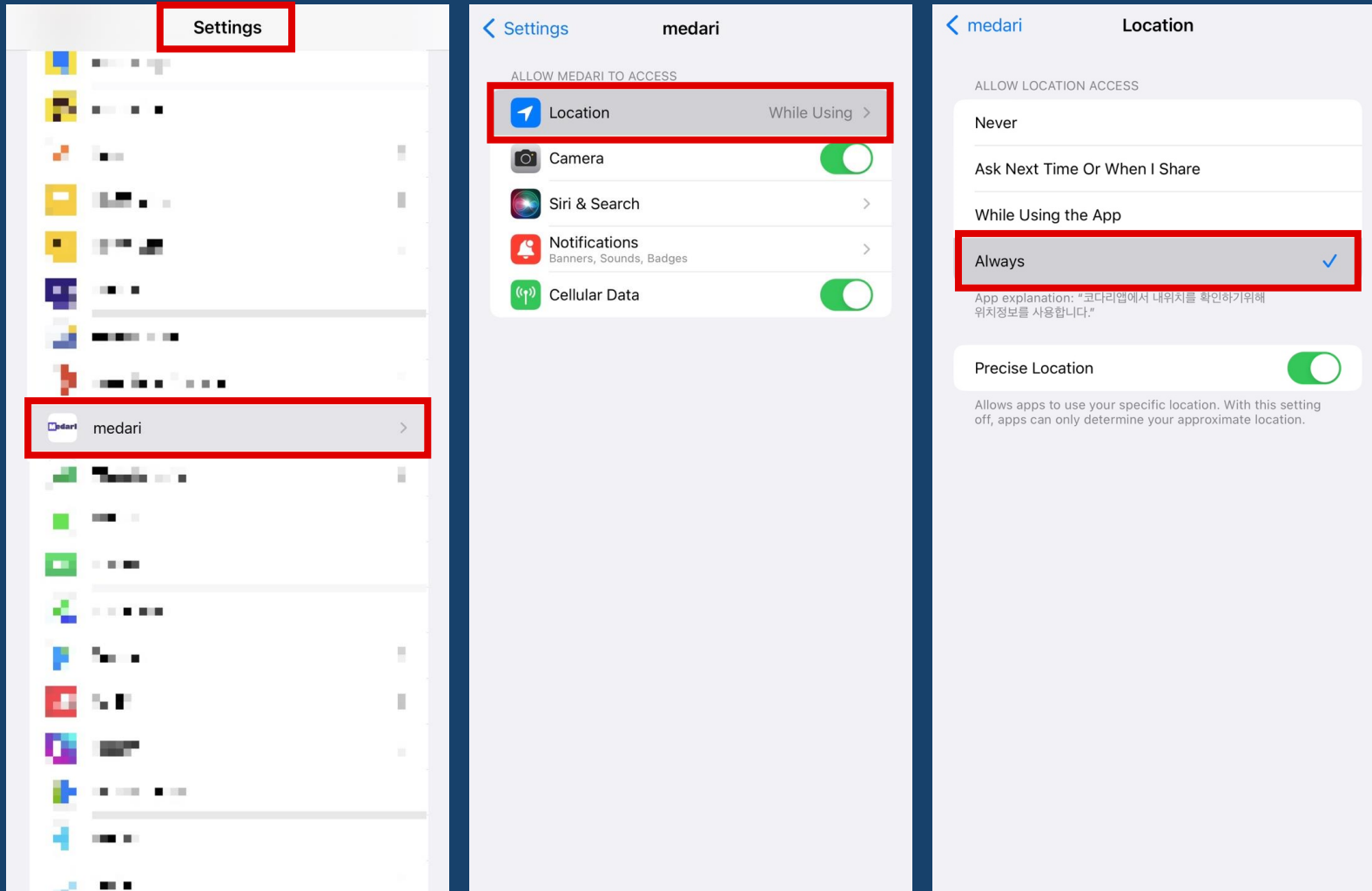

- ① Settings
- ② Click 'Medari'
- ③ Location
- ④ Click 'Always'

4. How to use MEDARI – HOME (Detailed Record of Place)

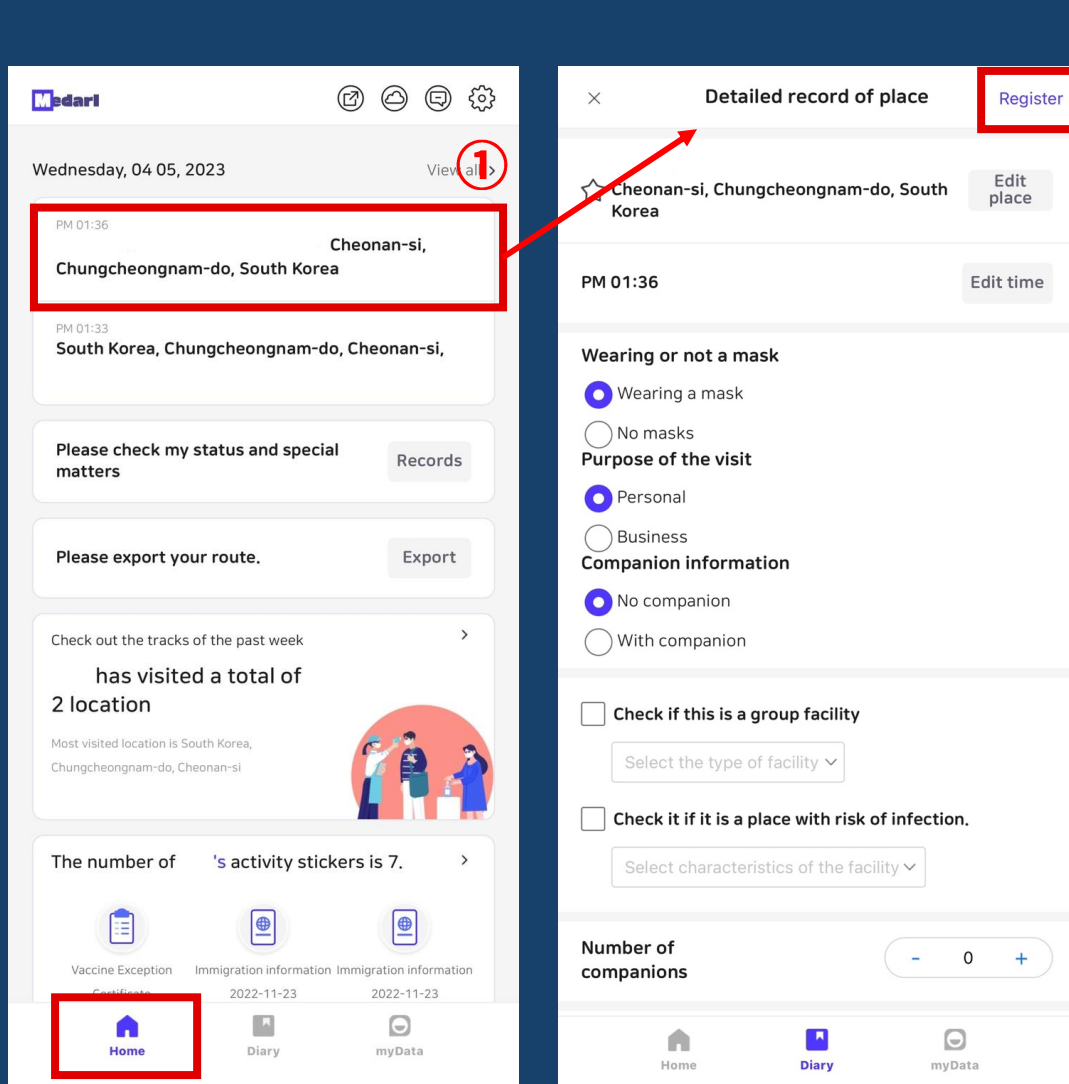

- ① Click on your current location information
- ② Enter whether or not to wear a mask, information about the companion, etc
- ③ Click 'Register'

*The information you registered can be found in [Diary].

4. How to use MEDARI – HOME (Daily Information Record)

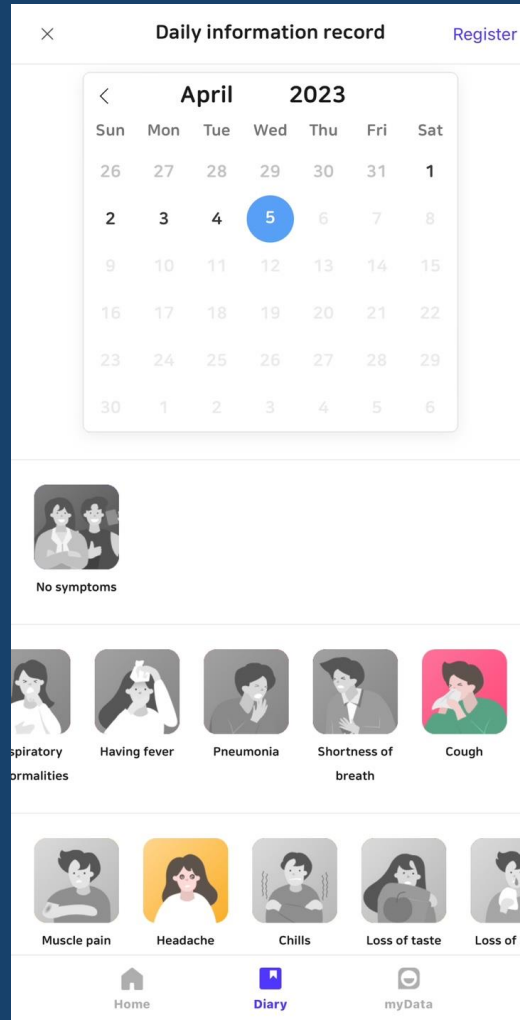
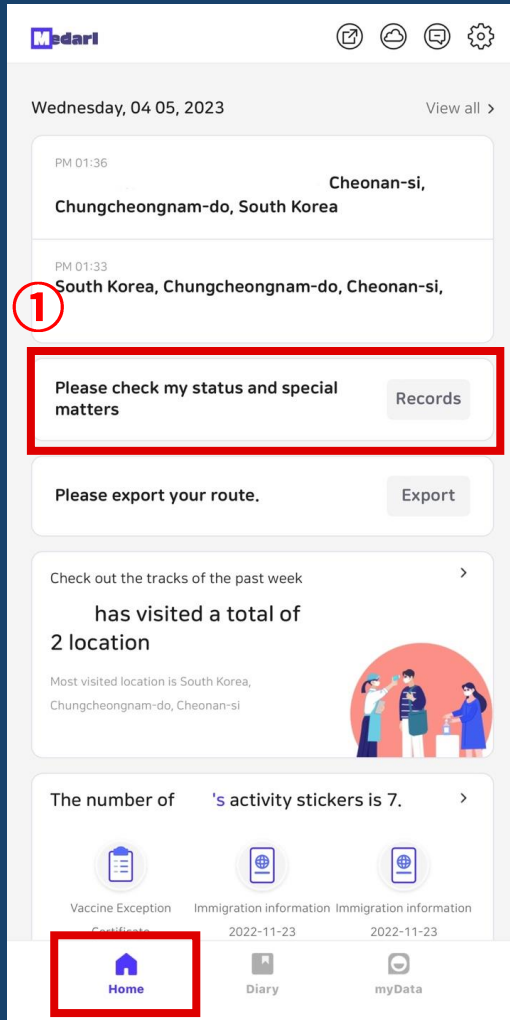

- ① Click to record your current status
- ② Select 'No Symptoms' if there are no symptoms, select the appropriate symptoms if there are any

4. How to use MEDARI – HOME (Daily Information Record)

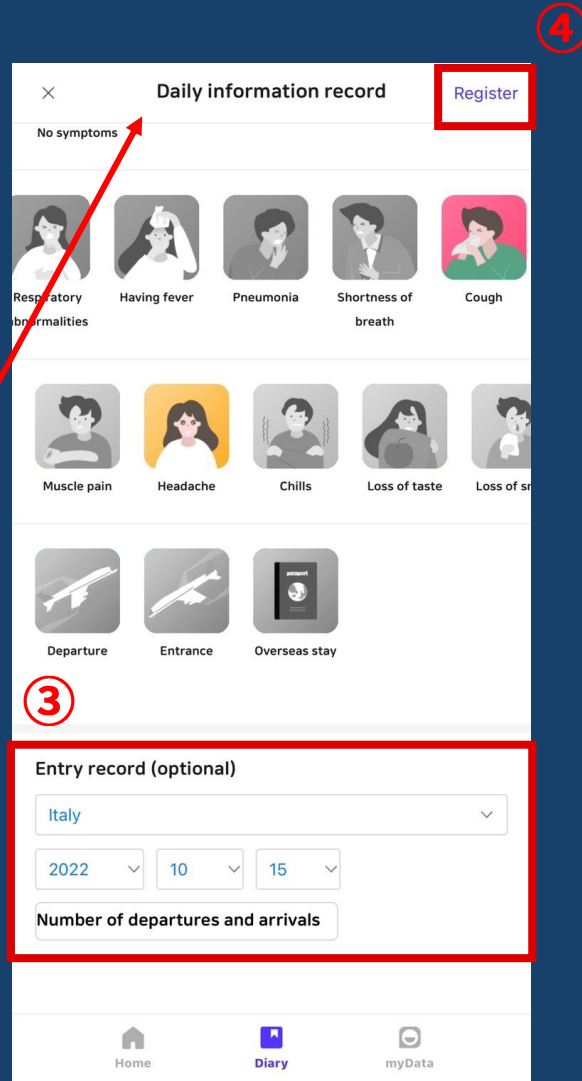
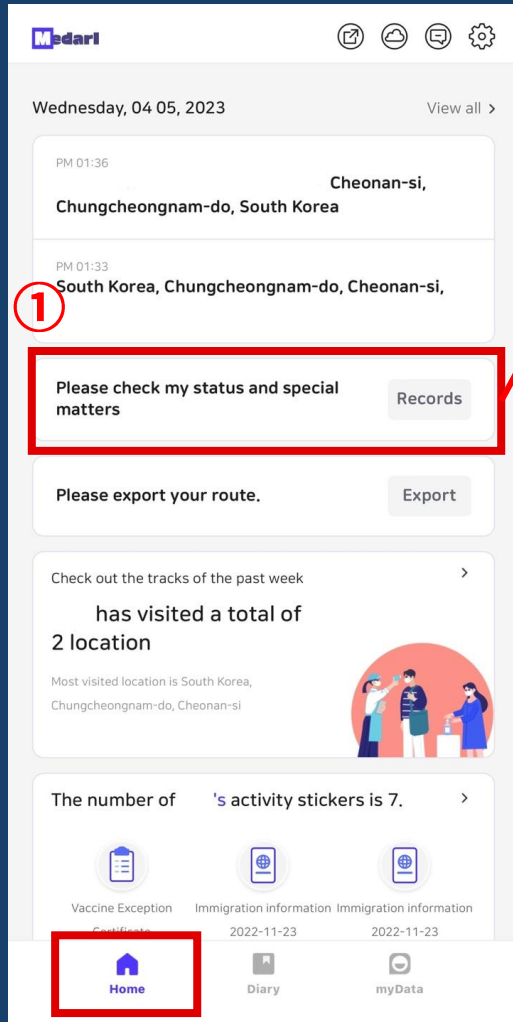

③ Complete your entry records if you have visited overseas

*You can enter the name of the country of visit, the date of visit, and the number of times of entry and exit.

*Immigration information can also be found in [My Data] > [Immigration information]

④ Click 'Register'

*The information you registered can be found in [Diary].

4. How to use MEDARI – HOME (Check Daily Information Record)

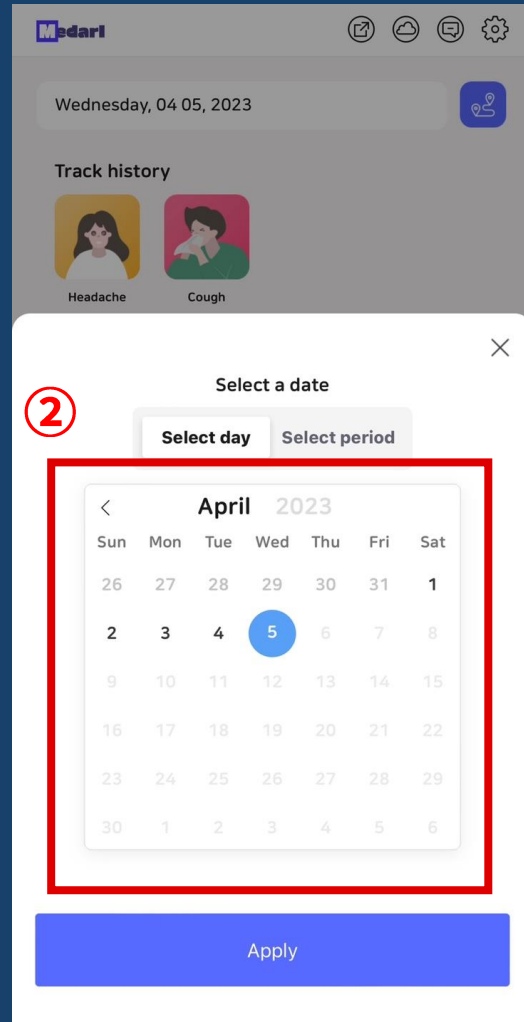
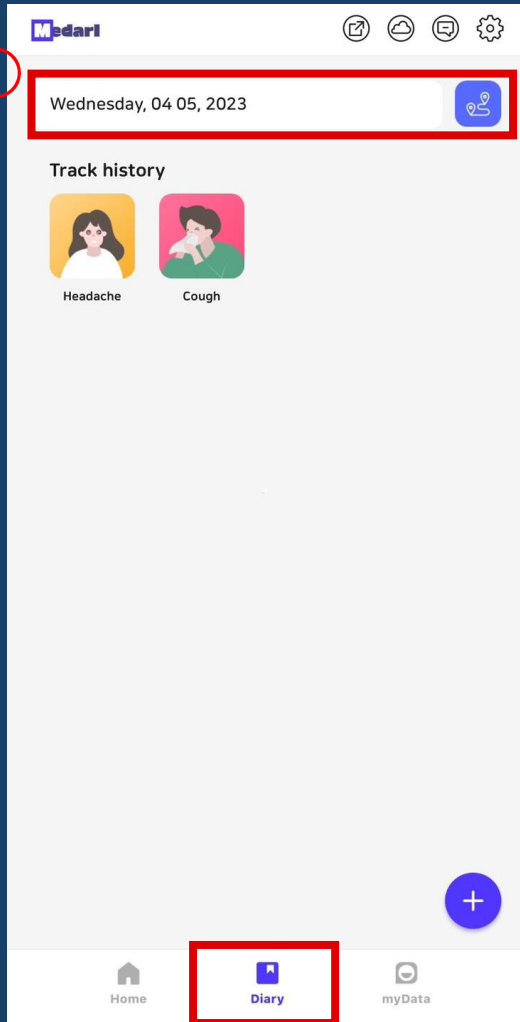

① Click a date in the [Diary]

② Click the date you want to confirm

4. How to use MEDARI – HOME (Check Daily Information Record)

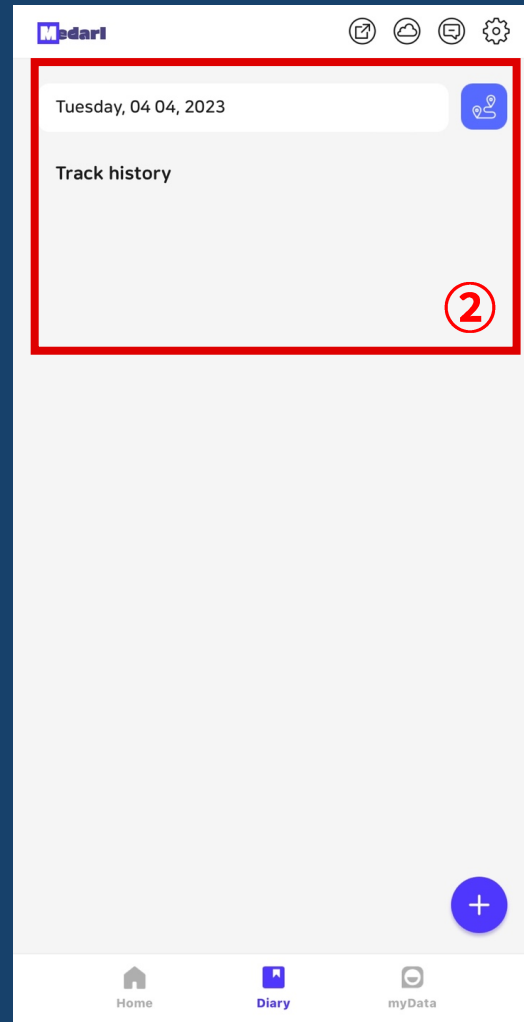
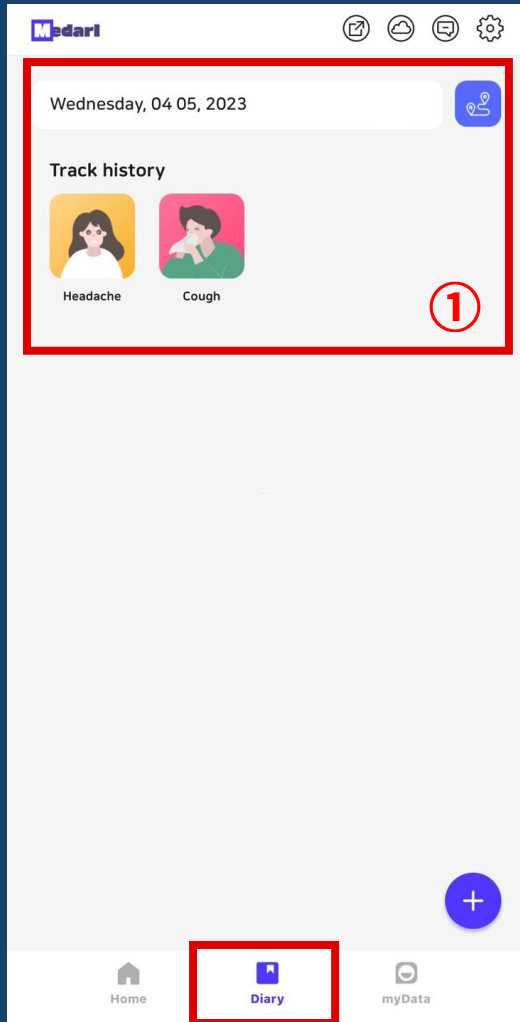

① Daily Symptom Recorded

② Daily Symptom is not Recorded

4. How to use MEDARI – HOME (Export Records)

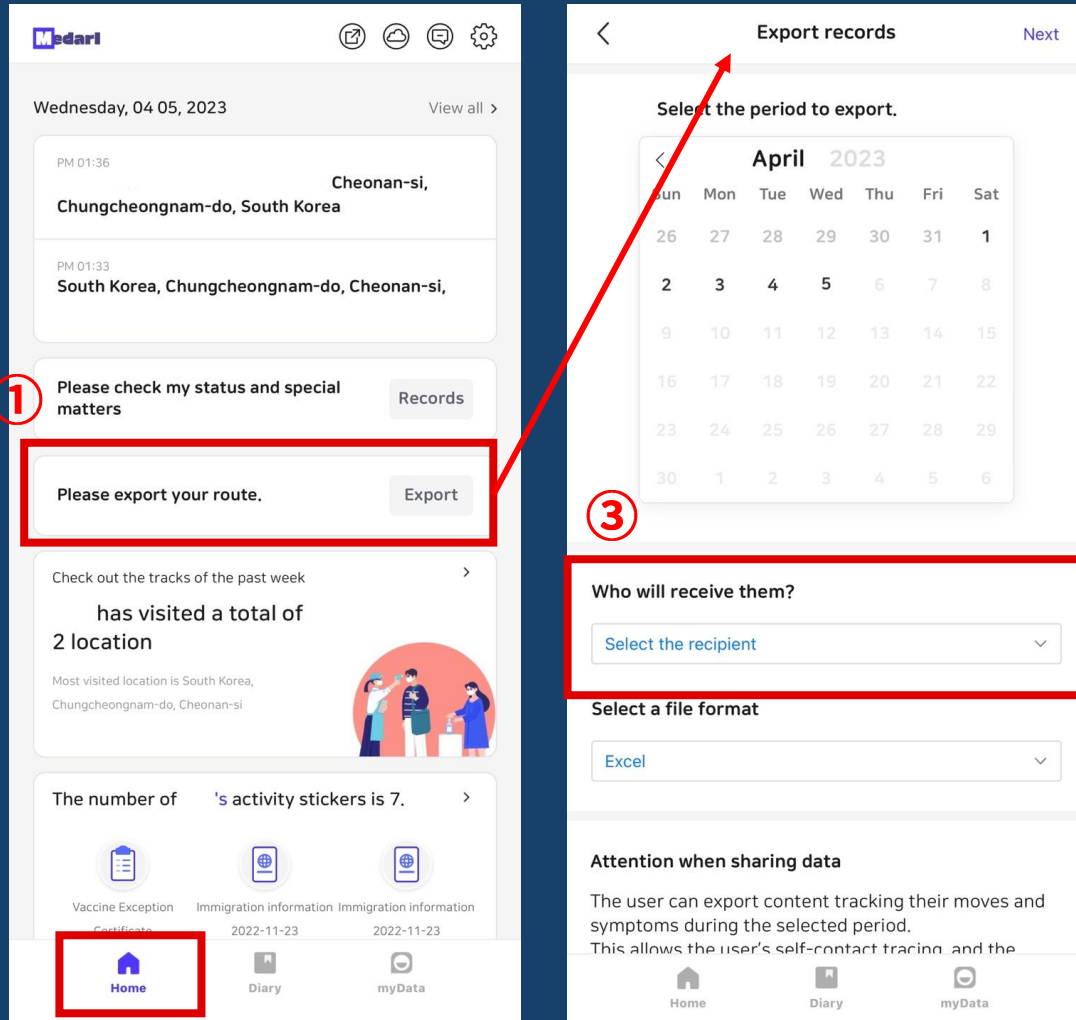

① Click 'Export records'

② Select the period to export

③ Select destinations to export

*You can export it to 'Myself' or to the 'Epidemiological investigator'

4. How to use MEDARI – HOME (Export Records)

Export records ⑤ Next

Name (mandatory)

Gender
 Male Female

Nationality
 Domestic Abroad

Street Address -

City -

State or Province -

Zip or Postal Code -

Country or Region

Area code -

Number prefix -

Back of number -

Occupation (Name of workplace or school)

Home Diary myData

Export records Next

Attention when sharing data

The user can export content tracking their moves and symptoms during the selected period. This allows the user's self-contact tracing, and the information can be forwarded to the person in charge of the public health center to cooperate with the epidemiological investigation. The data export function for epidemiological investigations will be further developed and supported. *Caution: Information concerning the user's moves and companions, if any, and visits to infected areas are recorded and delivered as a file. Please forward it only to epidemiological investigators or users who can check the movement route if necessary.

Loading old data

Name (mandatory)

Gender
 Male Female

Nationality

메일 Kakaotalk Message Link

④ Enter additional information

⑤ Click 'Next'

⑥ Export the way you want it

*Sharing through Kakao Talk can only be sent to those who have subscribed to the Medari through Kakao Talk

*The service to the epidemiologist is currently being tested

*Records can be sent when entering epidemiological investigators' e-mails and phone numbers

4. How to use MEDARI – HOME (Check Exported Records)

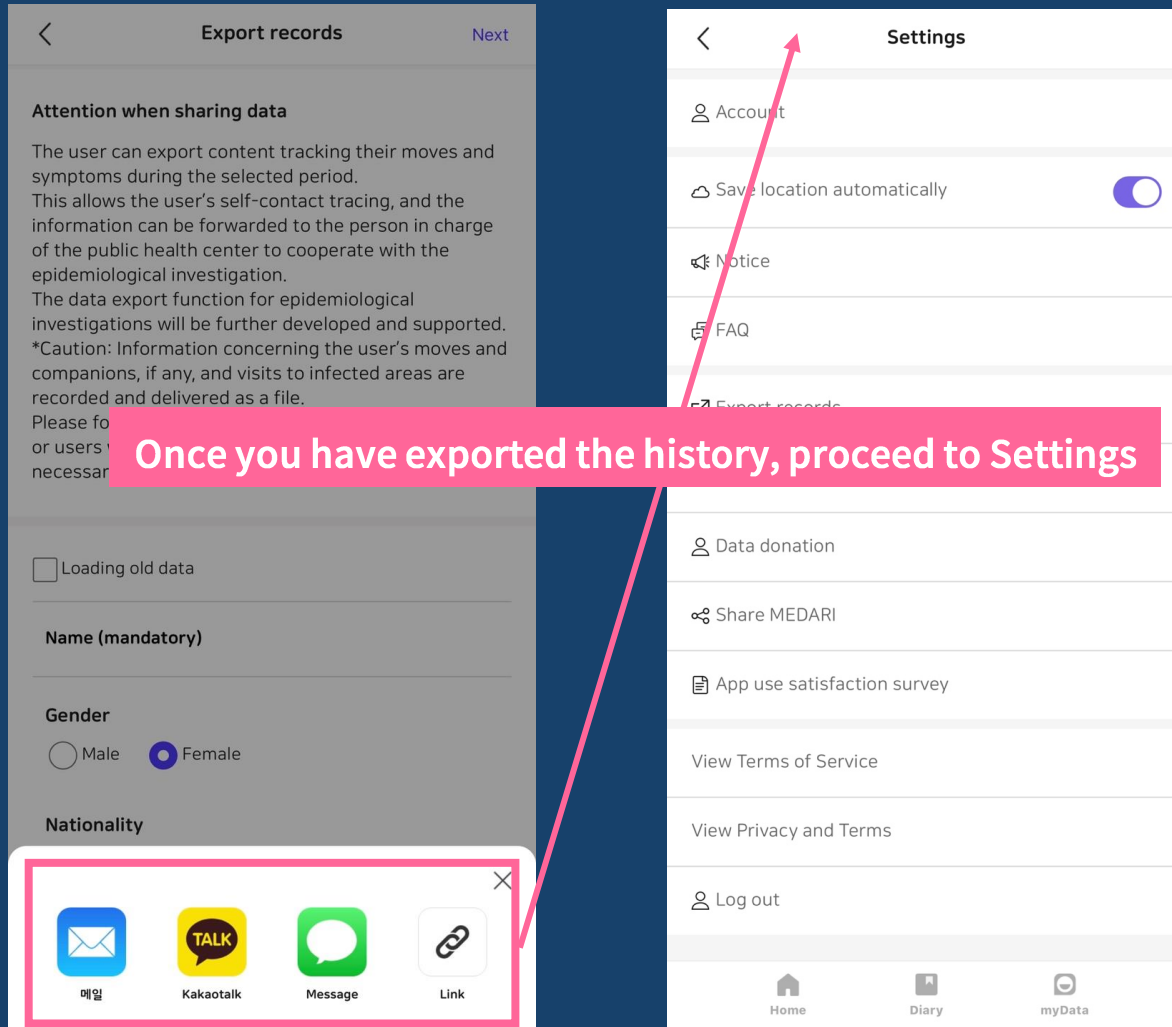

Export History List

*You can check up to 10 exported records.

4. How to use MEDARI – HOME

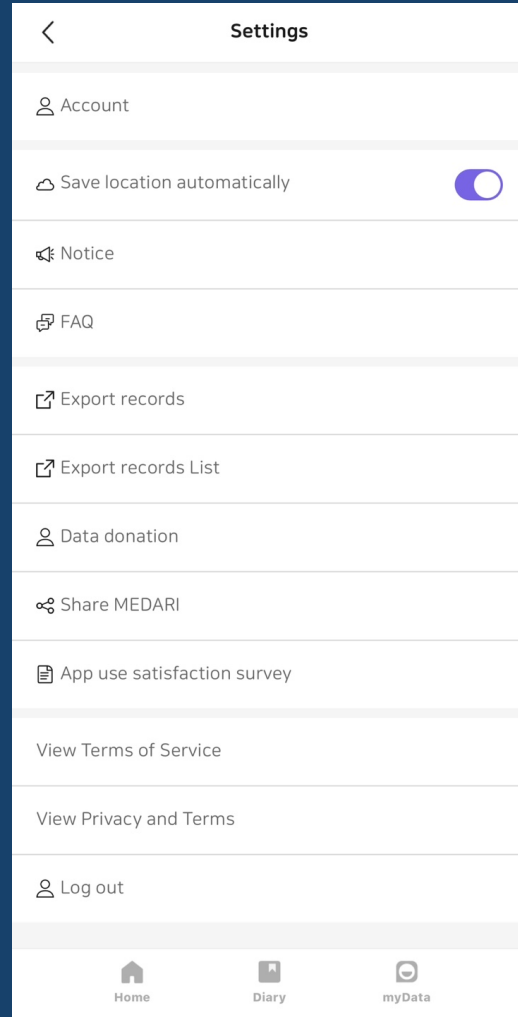
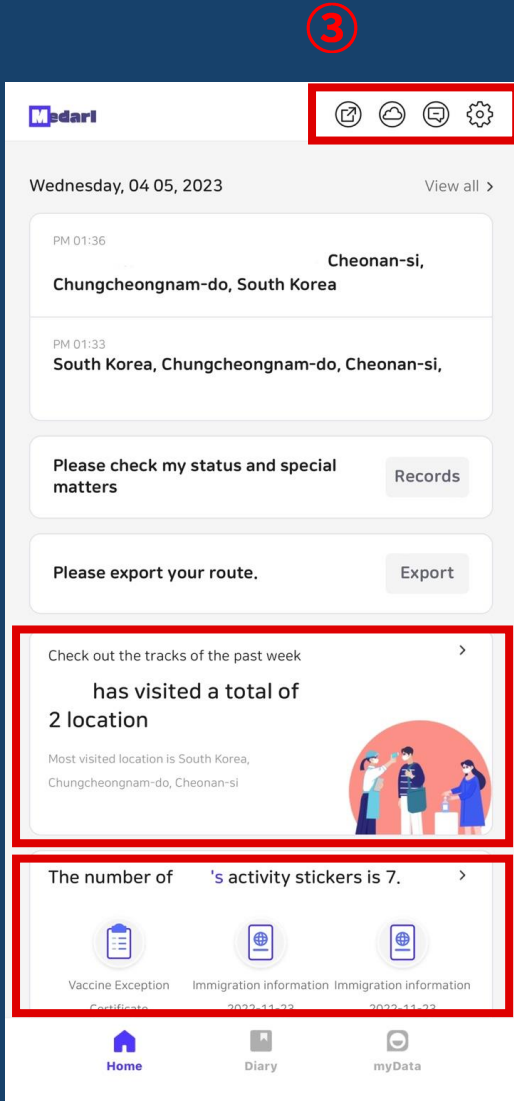

- ① You can check the places you visited over the past week in the form of 'map' or 'list'.
- ② You can check the history registered in [My Data]

③ Simple contents



[Export Records]



[Data Donation]



[Notice]



[Settings]

4. How to use MEDARI – Settings / Data Donation

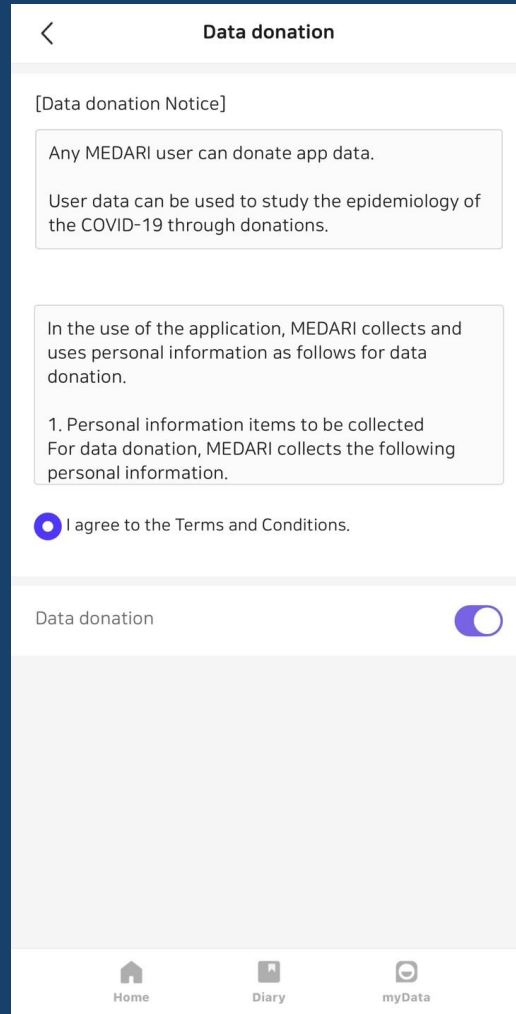
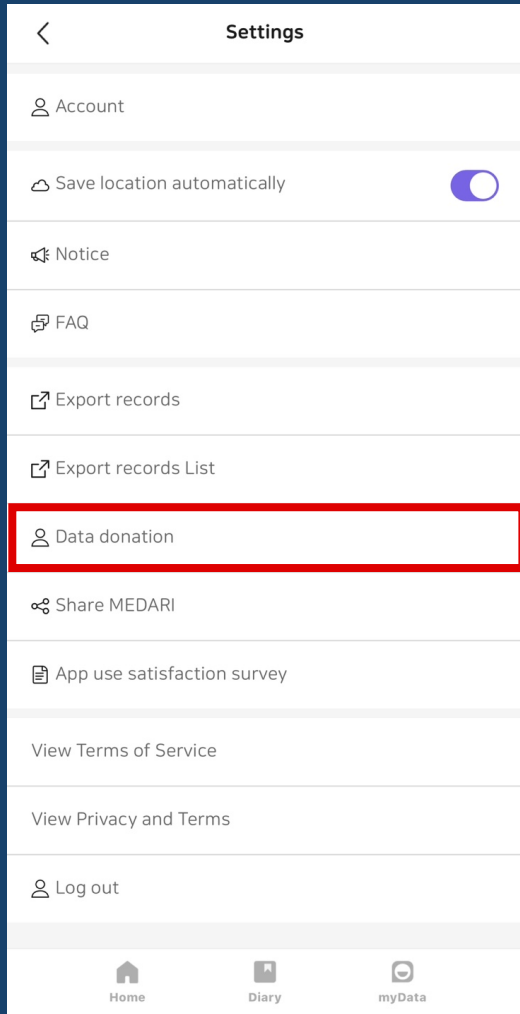

Settings > Data Donation

Objective: To be used for epidemiological study of COVID-19 infectious diseases

Continuous research to overcome infectious diseases

Collection items: demographic information, route, vaccination information, PCR inspection information, etc

5. How to use MEDARI – My Data (Vaccination)

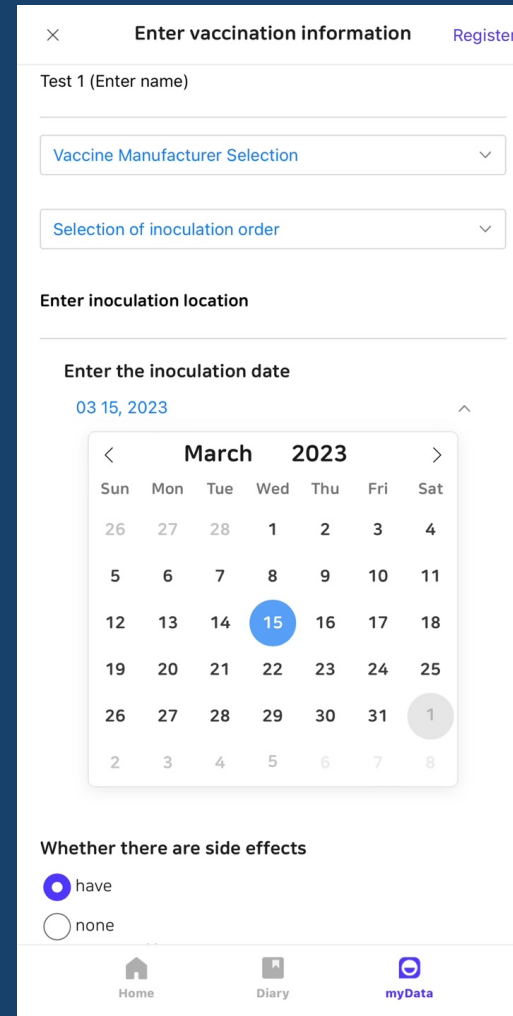
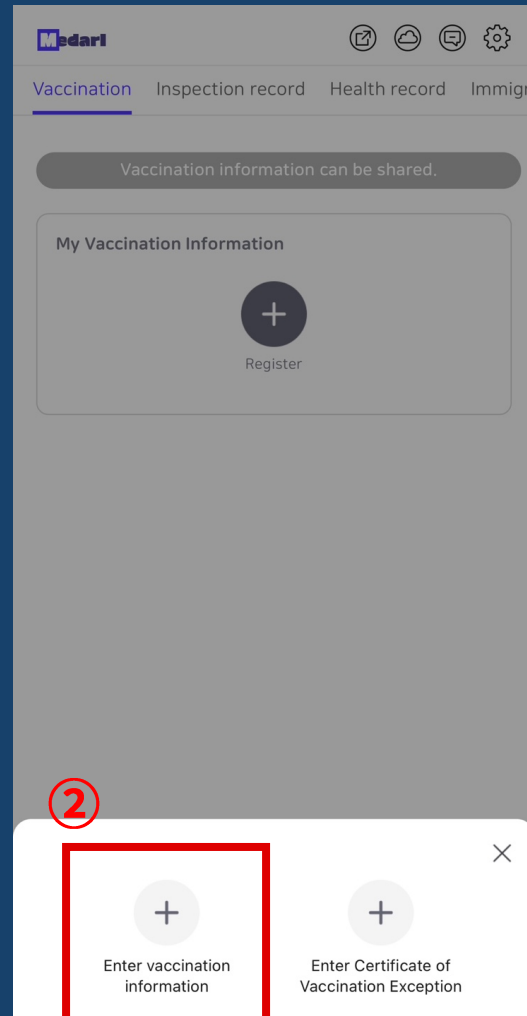
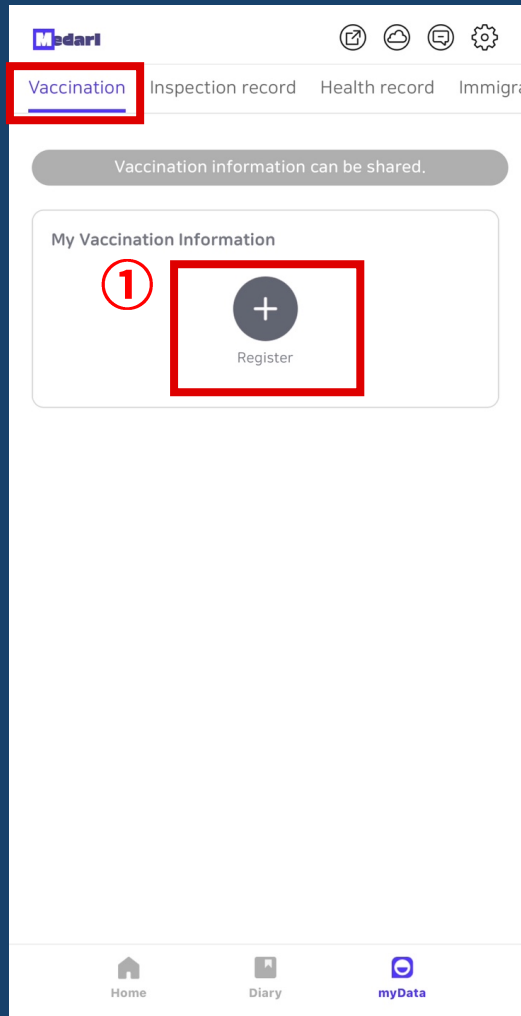

- ① Click 'Register'
- ② Click 'Enter vaccination Information'
- ③ Enter name, vaccine manufacturer, inoculation order, inoculation date, side effects etc.

*Side effects can be entered descriptively

5. How to use MEDARI – My Data (Vaccination)

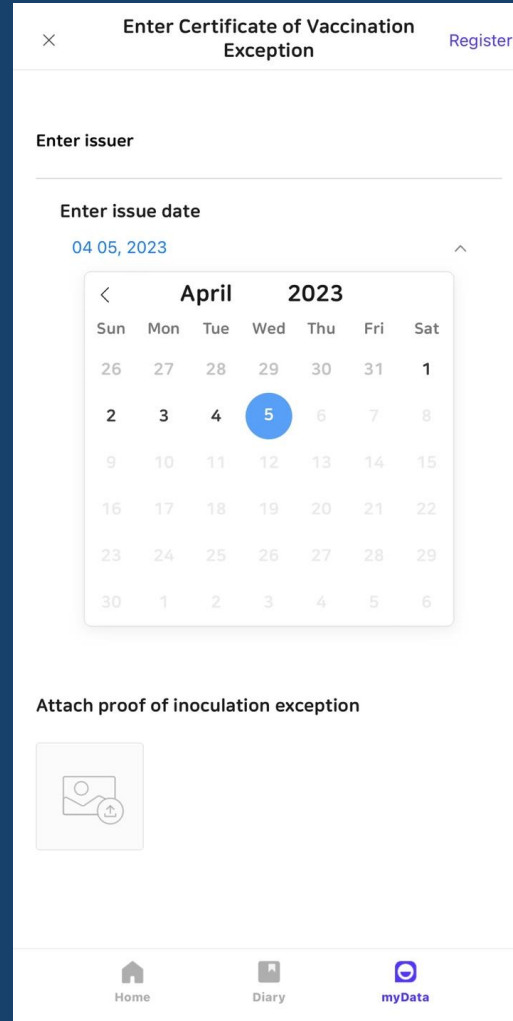
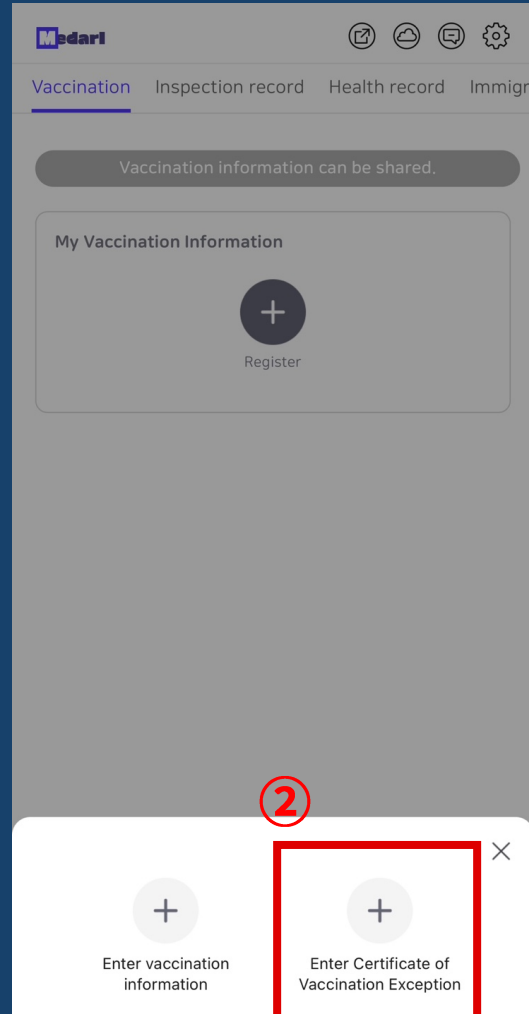
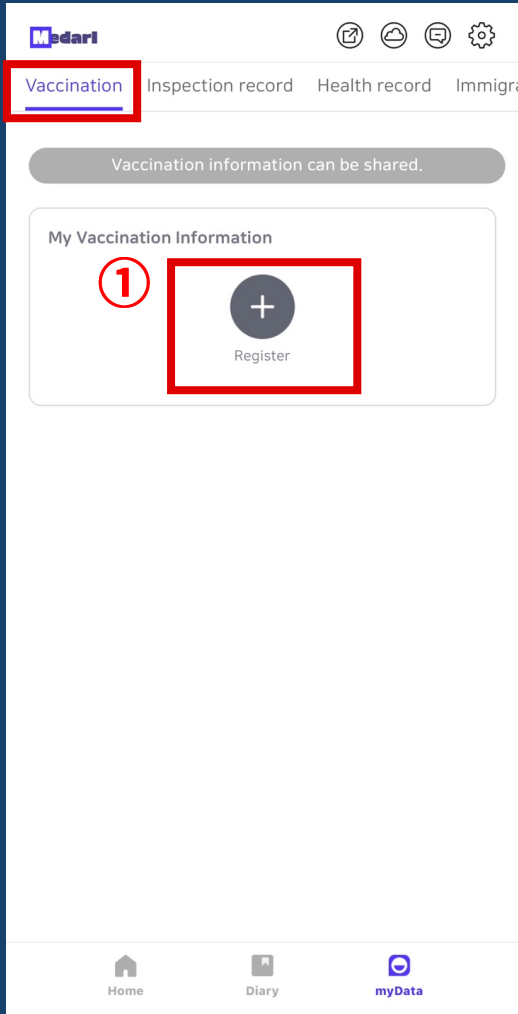

- ① Click 'Register'
- ② Click 'Enter Certificate of Vaccination Exception'
- ③ Enter issuer, issue date etc.

*Attaching proof of vaccination exception (image, file, etc.) is required

5. How to use MEDARI – My Data (Inspection Record)

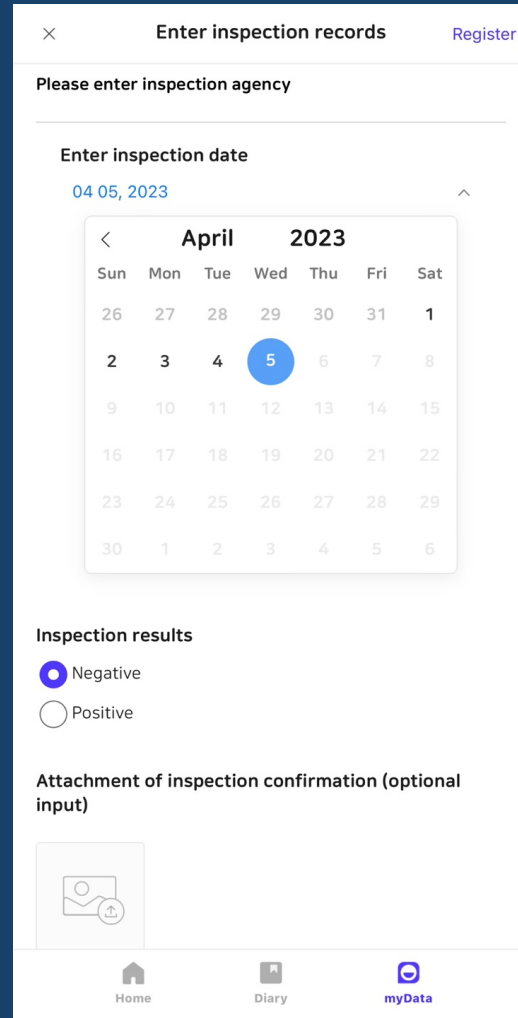
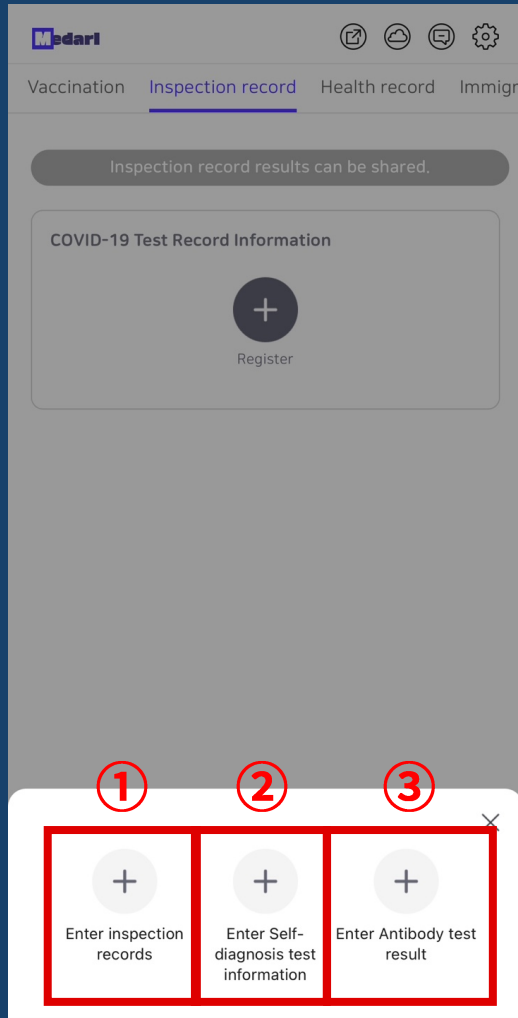

Registration of PCR inspection

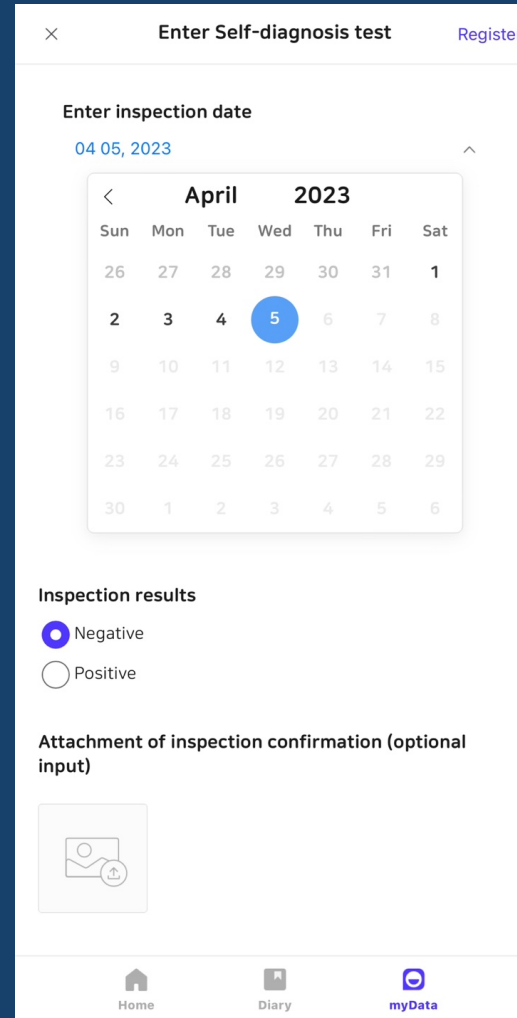

Registration of Self-diagnosis test

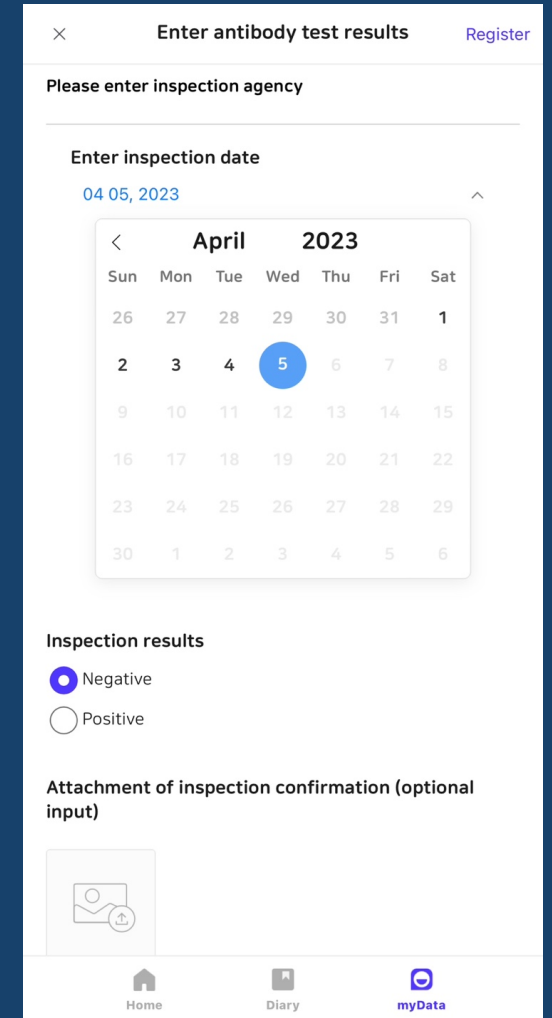

Registration of antibody test results

5. How to use MEDARI – My Data (Health Record)

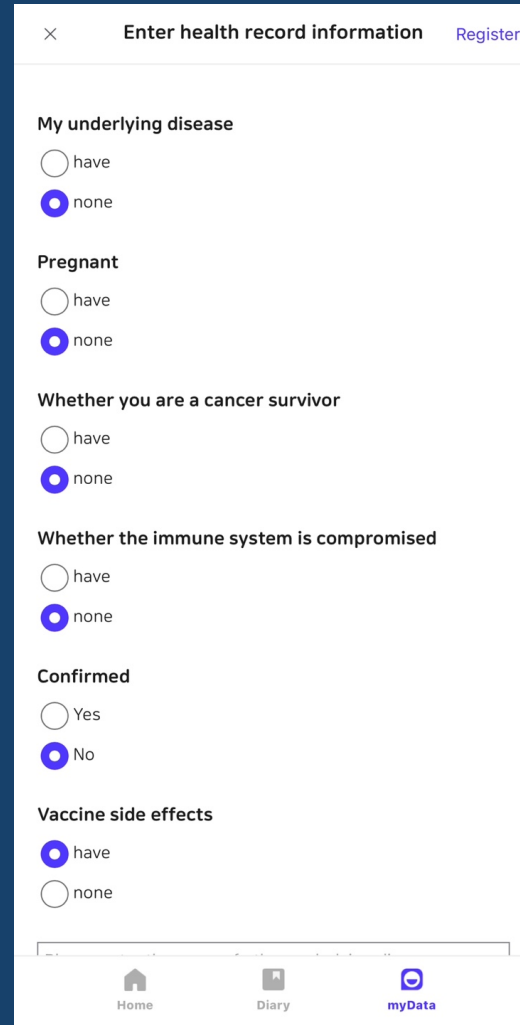
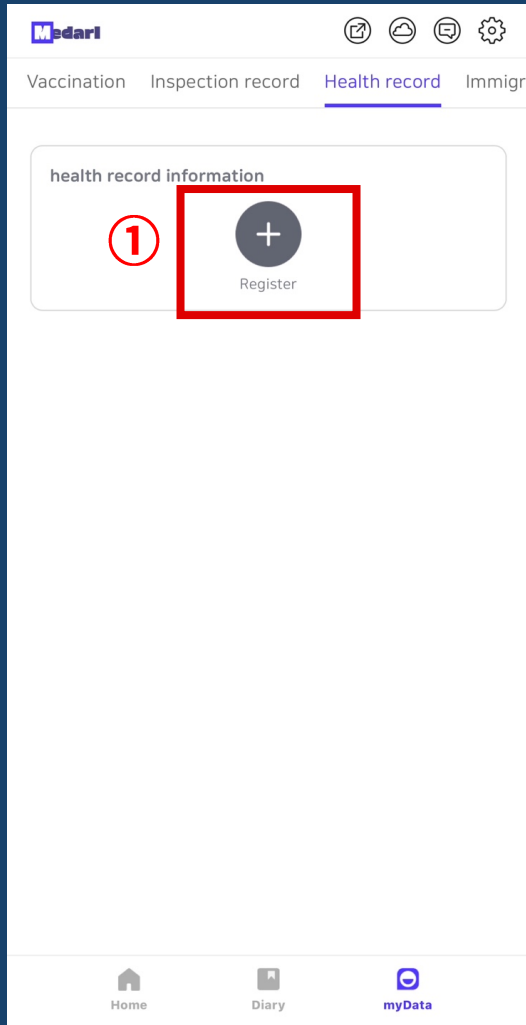

- ① Click 'Register'
- ② Enter health record information
- ③ Click 'Register'

5. How to use MEDARI – My Data (Immigration Information)

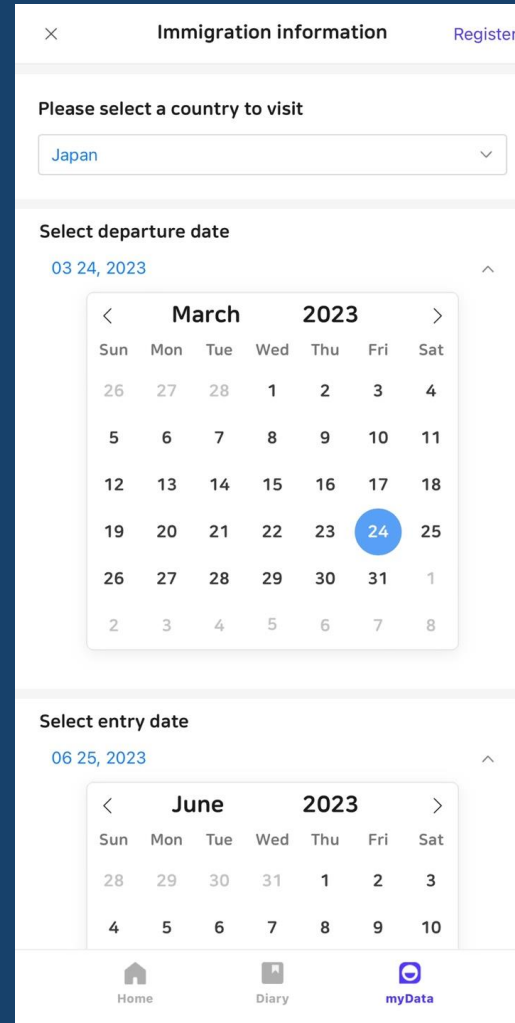
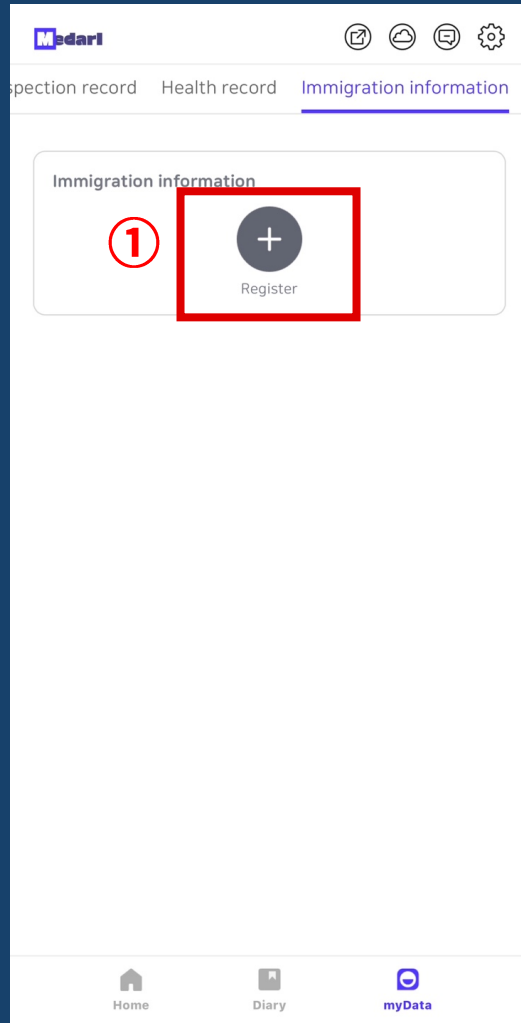

- ① Click 'Register'
- ② Enter immigration information
- ③ Click 'Register'

**THANK
YOU**